

CONSTRUCTION OF RIGHT
TURN LANE ON NORTHBOUND
US 401 AT LOWELL RIDGE
ROAD IN WAKE COUNTY

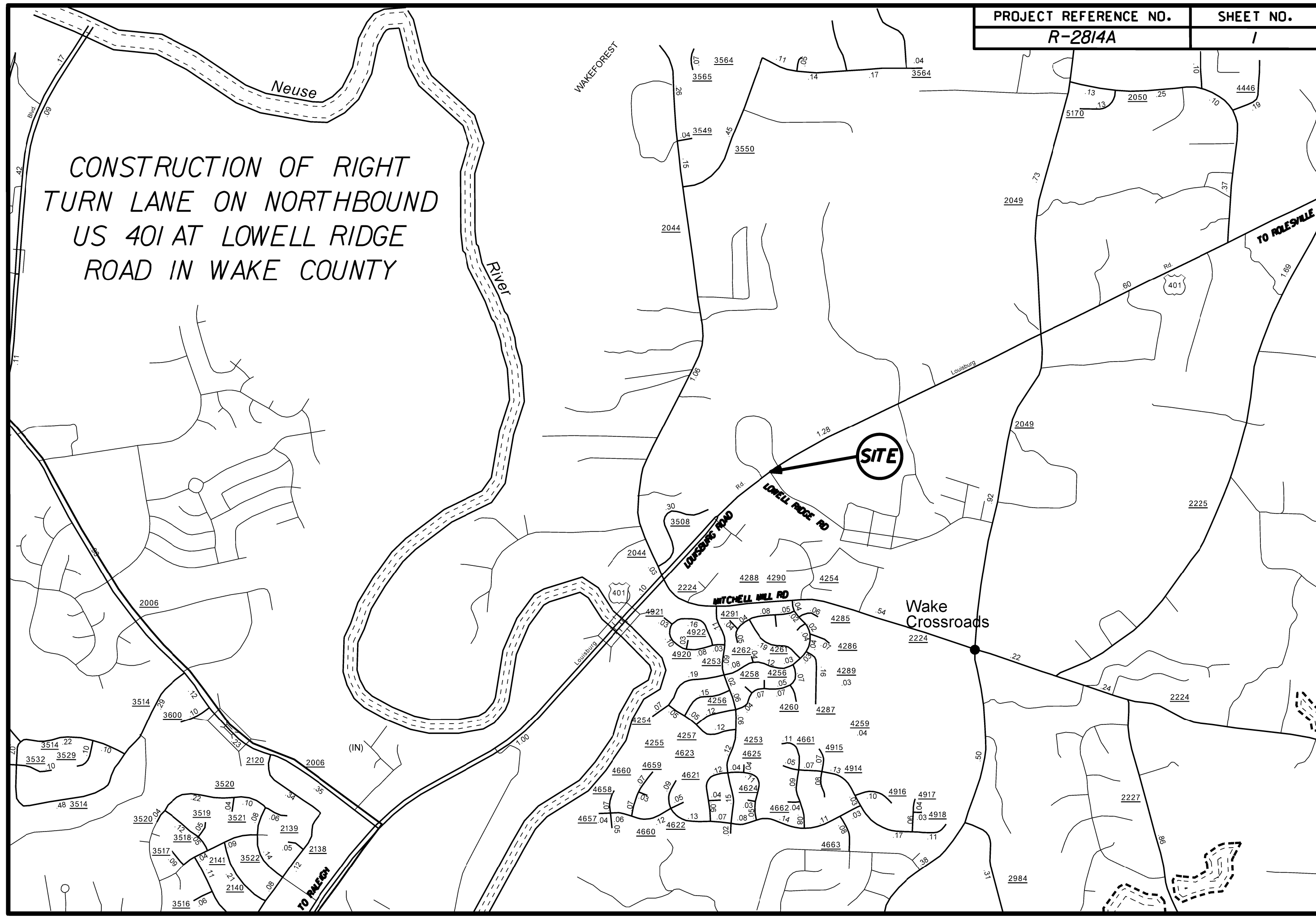





PROJECT REFERENCE NO.	SHEET NO.
R-2814A	2-C
ROADWAY DESIGN ENGINEER	PAVEMENT DESIGN ENGINEER

PAVEMENT SCHEDULE

C1	PROP. APPROX. 40 mm ASPHALT CONC. SURFACE COURSE, TYPE S9.5C, AT AN AVERAGE RATE OF 96 kg PER SQ. METER.
C2	PROP. APPROX. 80 mm ASPHALT CONC. SURFACE COURSE, TYPE S9.5C, AT AN AVERAGE RATE OF 96 kg PER SQ. METER IN EACH OF TWO LAYERS.
D1	PROP. APPROX. 100 mm ASPHALT CONC. INTERMEDIATE COURSE, TYPE I19.0C, AT AN AVERAGE RATE OF 245 kg PER SQ. METER.
E2	PROP. APPROX. 100 mm ASPHALT CONC. BASE COURSE, TYPE B25.0C, AT AN AVERAGE RATE OF 245 kg PER SQ. METER
T	EARTH MATERIAL.
U	EXISTING PAVEMENT.
V	MILLING BITUMINOUS PAVEMENT. 40mm DEPTH.

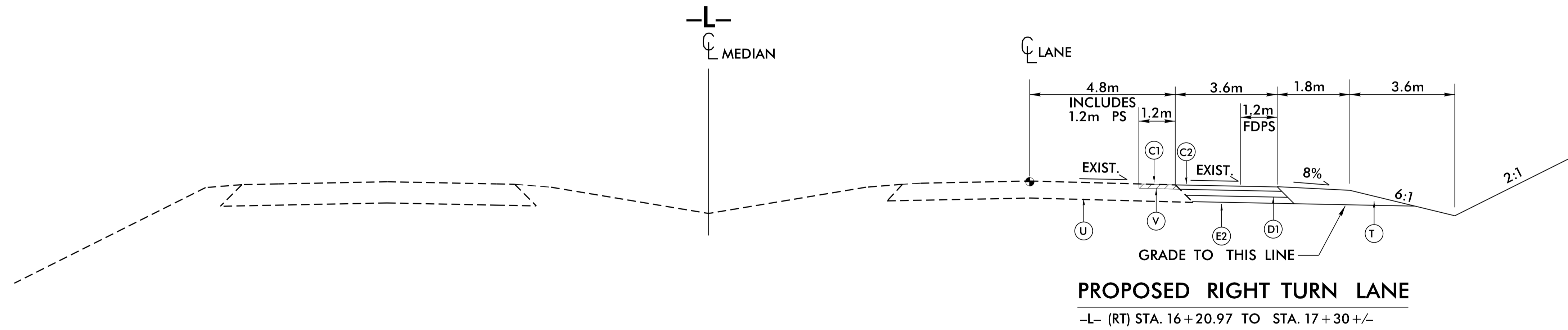
NOTE: PAVEMENT EDGE SLOPES ARE 1:1 UNLESS SHOWN OTHERWISE.

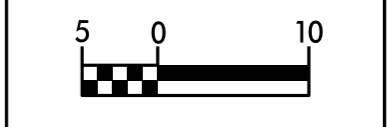

CONST. REV.

R/W REV.

PROJECT REFERENCE NO.	SHEET NO.
R-2814A	6
R / W SHEET NO.	
ROADWAY DESIGN ENGINEER	HYDRAULICS ENGINEER

-L-	-Y2-	-Y3-
PI Sta 16+52.303	PI Sta 10+64.019	PI Sta 10+13.436
$\Delta = 21^{\circ} 27' 17.0''$ (RT)	$\Delta = 34^{\circ} 50' 28.7''$ (LT)	$\Delta = 19^{\circ} 04' 01.6''$ (LT)
L = 651.553	L = 51.779	L = 26.623
T = 329.637	T = 26.718	T = 13.436
R = 1,740.000	R = 85.150	R = 80.000
SE = 3.0%	SE = EXIST.	SE = RC
RO = 33m		RO = SEE PLANS

-Y10-
PI Sta 11+09.797
$\Delta = 61^{\circ} 49' 44.9''$ (LT)
L = 164.027
T = 91.023
R = 152.000
SE = NC

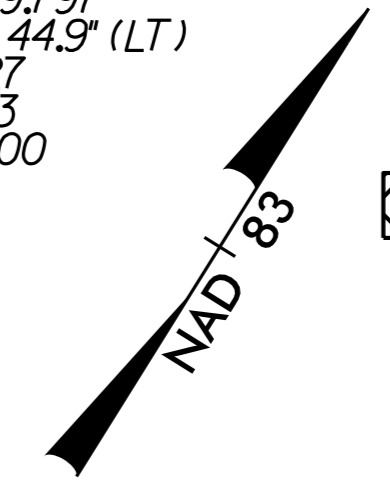

 PROP. PAINTED ISLAND SEE TRAFFIC CONTROL PLANS

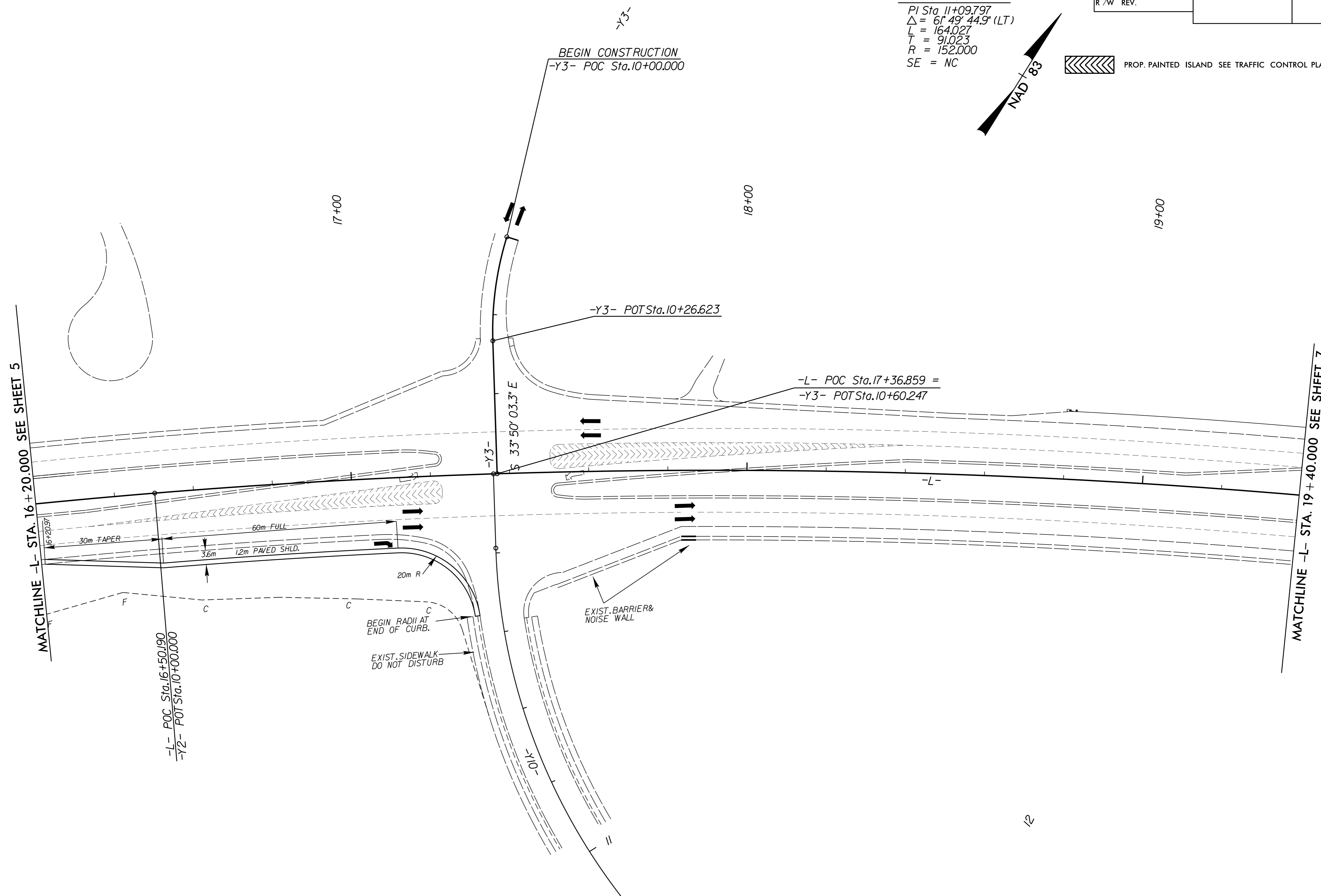

REVISIONS

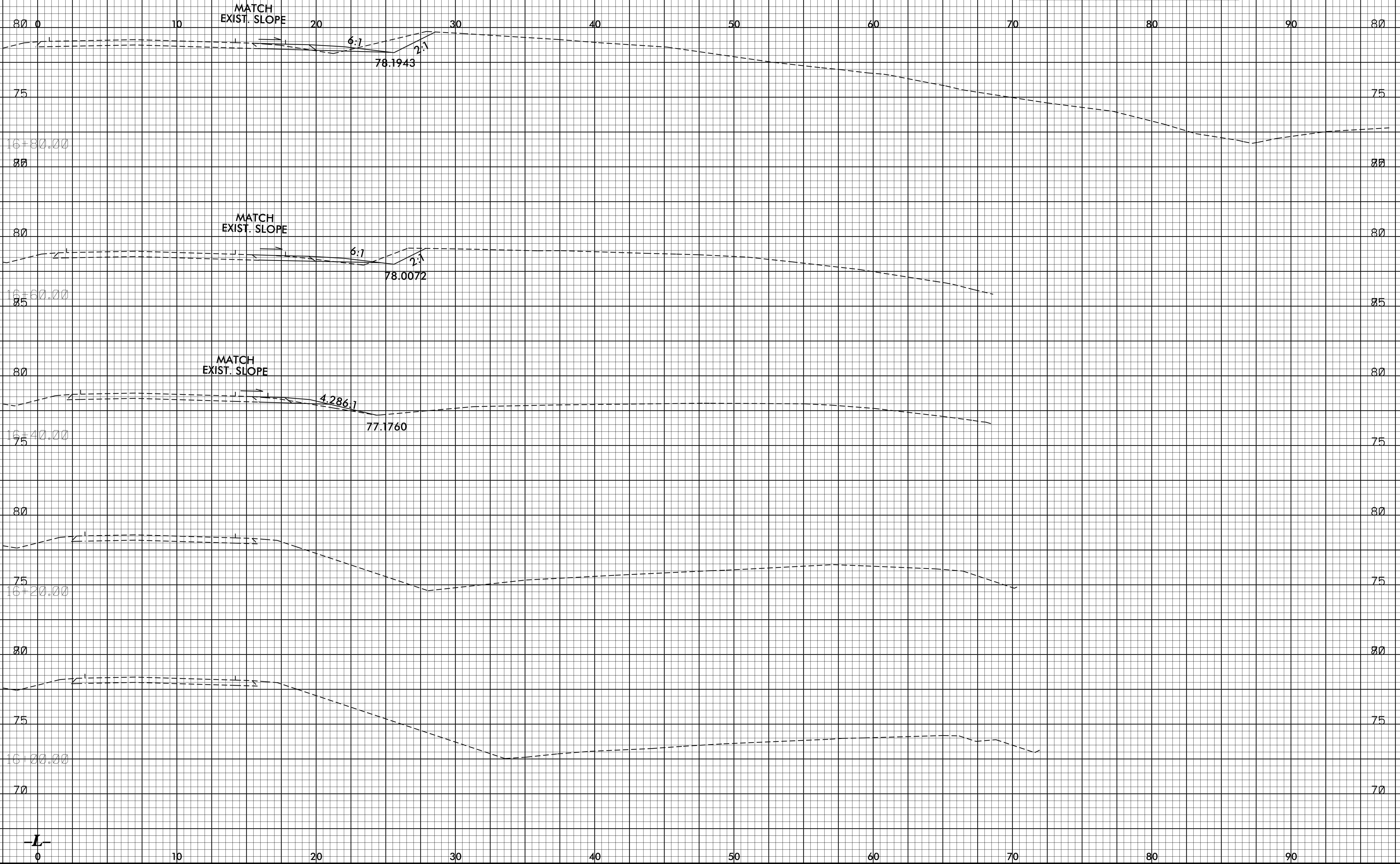
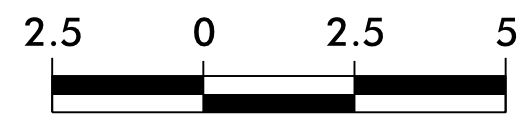

R:\projects\30-AUG-2012\13410\16+80\2814A_R-2814A.dwg, xpl, 11.dgn

R:\p\proj\130-AUG-2012\131\00_85541\257814A\02-555911_rridge\2814a_rdy_xpl1.dgn

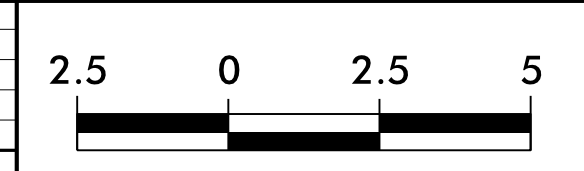

PROJECT REFERENCE NO.	SHEET NO.
R-2814A	X-2

